

4-input 4K UHD Switching HDBaseT Transmitter with USB host/device (4K: 100m/328ft)

SW-510-TX

WyreStorm

Specification Sheet

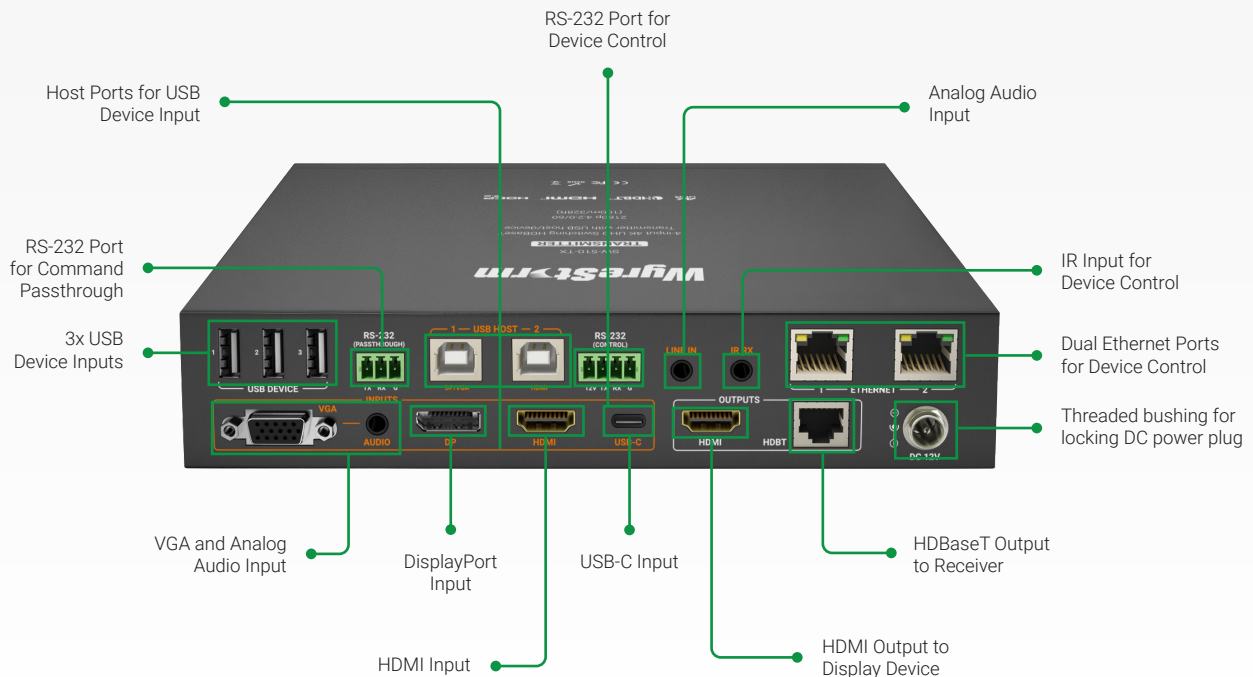

WyreStorm - Powerful. Reliable. Simple.

Introduction

When the next generation of HDBaseT transmission meets WyreStorm's presentation switcher platform, the result is this powerful switching transmitter, perfect for corporate meeting and classroom environments. Automatic switching inputs with USB host extension and CEC triggering mean an autonomous experience with no user input required.

Key Features

- Professional switching transmitter for education or corporate meeting rooms
- Automatic or manual switching between HDMI, VGA, DisplayPort and USB-C inputs
- Bidirectional USB2.0 for connection of webcams, smart touchscreens and microphones
- USB-C input supports Alt-mode functionality for AV and USB device connection through a single cable
- Automatic or manual CEC triggering for compatible connected screens or projectors
- Supports source content up to 4K/60 4:2:0 with HDCP 2.2

In the Box

1x SW-510-TX Transmitter
1x 12V DC Power Supply (US/UK/EU)
1x IR Receiver
2x Mounting Brackets

1x 3-pin Screw Down Phoenix Connector
1x 4-pin Screw Down Phoenix Connector
1x Quickstart Guide

Specifications

Audio and Video				
Inputs	1x VGA In: 15-pin VGA			
	1x Display Port In: DisplayPort 1.3			
	1x HDMI In: 19-pin type A			
	1x Audio In: 3.5mm (1/8in) TRS Stereo			
	1x Line In: 3.5mm (1/8in) TRS Stereo			
Outputs	1x HDMI Out: 19-pin type A			
	1x HDBT Out: 8-pin RJ-45 Female			
Video Encoding	HDBaseT Class C			
Encoding Data Rate	9.2Gbps			
End to End Latency	10μs (micro seconds)			
Audio Formats	2ch Analog/PCM Multichannel: LPCM			
Video Resolutions (Max)	Video Resolution	HDMI	Cat6	Cat6a/7
	1920x1200p @60Hz 8bit	15m/49ft	150m/492ft	150m/492ft
	1920x1080p @60Hz 8bit	15m/49ft	150m/492ft	150m/492ft
	3840x2160p @30Hz 8bit 4:4:4	7m/23ft	100m/328ft	100m/328ft
	4096x2160p @60Hz 8bit 4:2:0	7m/23ft	100m/328ft	100m/328ft
Supported Standards	DCI RGB			
Maximum Pixel Clock	297MHz			
Communication and Control				
HDMI	HDMI HDCP 2.2 EDID DVI/D supported with adapter (not included)			
HDBaseT	HDMI HDCP 2.2 EDID CEC 2ch audio USB			
Ethernet	2x 8-pin RJ-45 female Bidirectional over HDBaseT			
RS-232	1x RS-232 (Control): 3-pin Phoenix 1x RS-232 (Passthrough): 3-pin Phoenix			
IR	1x IR RX: 3.5mm (1/8in) TS Mono			
USB	1x USB-C: USB 3.1 Audio/Video 2x USB Host: USB-B 3x USB Device: USB-A			
Power				
Power Supply	12V DC 2A			
Max Power Consumption	14.02W			
Environmental				
Operating Temperature	0 to + 45°C (32 to + 113 °F), 10% to 90%, non-condensing			
Storage Temperature	-20 to +70°C (-4 to + 158 °F), 10% to 90%, non-condensing			
Maximum BTU	56.3BTU/hr			
Dimensions and Weight				
Rack Units/Wall Box	<1U			
Height With Without Feet	44.5mm/1.76in 42mm/1.66in			
Width With Without Brackets	263mm/10.36in 220mm/8.67in			
Depth With Without Handles	148.7mm/5.86in 148.7mm/5.86in			
Weight	0.97kg/2.13lbs			
Regulatory				
Safety and Emission	CE FCC RoHS			

Right Product for the Right Application.

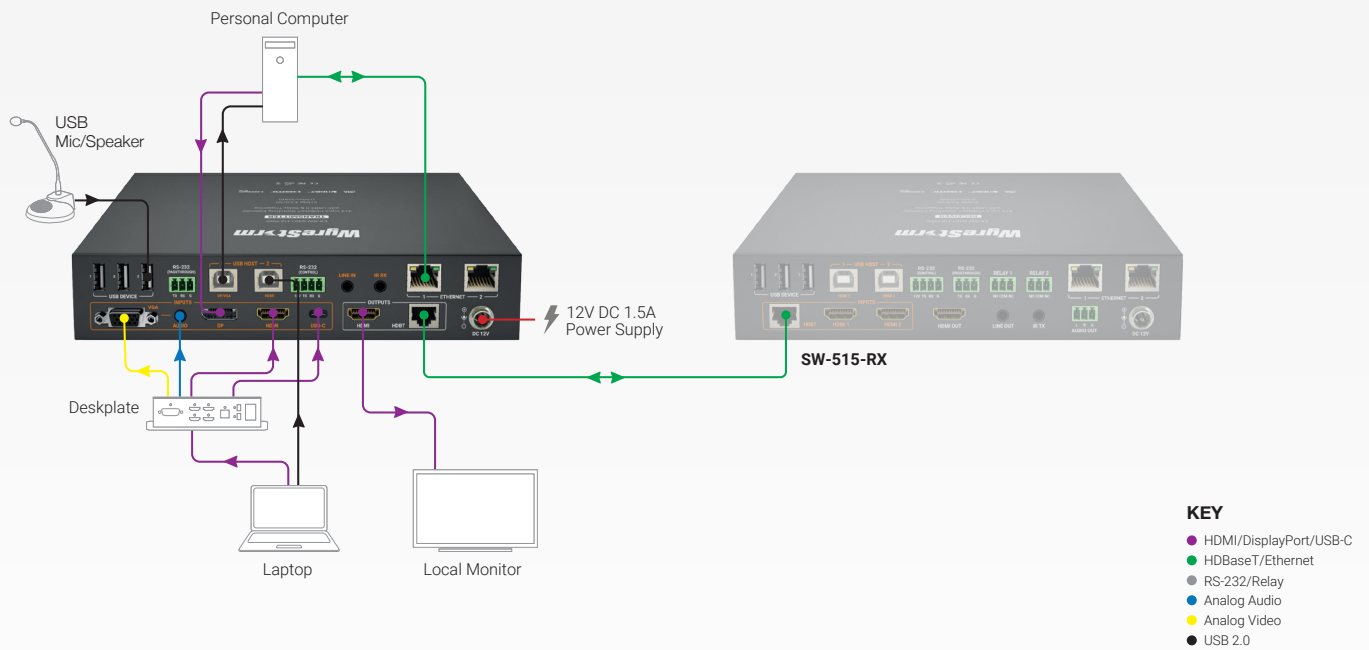

Note: WyreStorm reserves the right to change product specification, appearance or dimensions of this product at any time without prior notice.

3-input 4K UHD Switching HDBaseT Receiver with USB Host/Device Ports & Dual Ethernet (4K: 100m/328ft)

SW-515-RX

WyreStorm

Specification Sheet

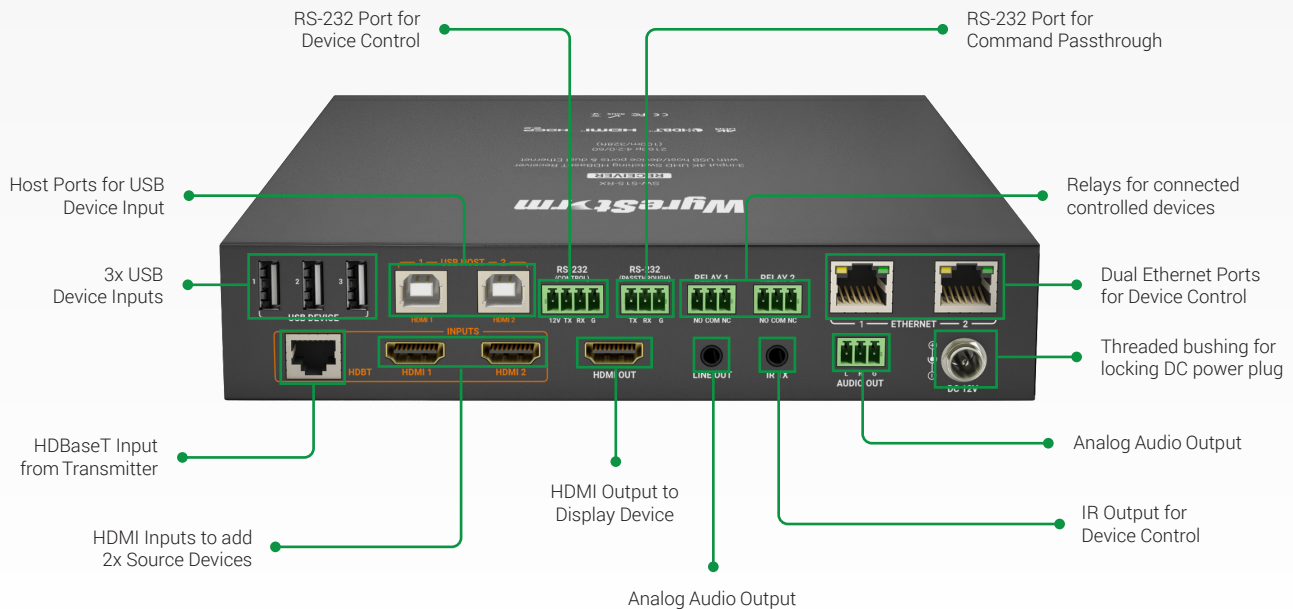

WyreStorm - Powerful. Reliable. Simple.

Introduction

Powerful, next generation HDBaseT receiver compatible with WyreStorm's presentation switcher platform, perfect for corporate meeting and classroom environments. Automatically switches between a remote source sent over HDBaseT and 2 local HDMI sources, all with USB device extension. CEC triggering and 3rd party device relays further contribute to a superior and autonomous presentation experience.

Key Features

- HDBaseT receiver with switching inputs for education or corporate meeting rooms
- Automatic or manual switching between a remote HDBaseT source or 2 local HDMI's
- Bidirectional USB2.0 for connection of webcams, smart touchscreens and microphones
- Automatic or manual CEC triggering for compatible connected screens or projectors
- Condition based relays triggered on source presence
- Supports source content up to 4K/60 4:2:0 with HDCP 2.2

In the Box

1x SW-515-RX Transmitter
1x 12V DC Power Supply (US/UK/EU)
1x IR Transmitter
2x Mounting Brackets

4x 3-pin Screw Down Phoenix Connector
1x 4-pin Screw Down Phoenix Connector
1x Quickstart Guide

Specifications

Audio and Video				
Inputs	2x HDMI: 19-pin type A 1x HDBT In: 8-pin RJ-45 Female			
Outputs	1x HDMI Out: 19-pin type A 1x Audio Out: 3-pin Phoenix 1x Line Out: 3.5mm (1/8in) TRS Stereo			
Video Encoding	HDBaseT Class C			
Encoding Data Rate	9.2Gbps			
End to End Latency	10μs (micro seconds)			
Audio Formats	2ch Analog/PCM Multichannel: LPCM			
Video Resolutions (Max)	Video Resolution	HDMI	Cat6	Cat6a/7
	1920x1200p @60Hz 8bit	15m/49ft	150m/492ft	150m/492ft
	1920x1080p @60Hz 8bit	15m/49ft	150m/492ft	150m/492ft
	3840x2160p @30Hz 8bit 4:4:4	7m/23ft	100m/328ft	100m/328ft
	4096x2160p @60Hz 8bit 4:2:0	7m/23ft	100m/328ft	100m/328ft
Supported Standards	DCI RGB			
Maximum Pixel Clock	297MHz			
Communication and Control				
HDMI	HDMI HDCP 2.2 EDID DVI/D supported with adapter (not included)			
HDBaseT	HDMI HDCP 2.2 EDID CEC 2ch audio USB			
Ethernet	2x 8-pin RJ-45 female Web UI IP Control Bidirectional over HDBaseT			
RS-232	1x RS-232 (Control): 3-pin Phoenix 1x RS-232 (Passthrough): 3-pin Phoenix			
IR	1x IR TX: 3.5mm (1/8in) TS Mono			
Relays	1x Screen UP: 3-pin Phoenix 1x Screen DWN: 3-pin Phoenix			
USB	2x USB Host: USB-B 3x USB Device: USB-A USB over HDBT limited to 190Mbps Max 5v 500mA per USB Type A			
Power				
Power Supply	12V DC 2A			
Max Power Consumption	16.25W			
Environmental				
Operating Temperature	0 to + 45°C (32 to + 113 °F), 10% to 90%, non-condensing			
Storage Temperature	-20 to +70°C (-4 to + 158 °F), 10% to 90%, non-condensing			
Maximum BTU	55BTU/hr			
Dimensions and Weight				
Rack Units/Wall Box	<1U			
Height With Without Feet	44.5mm/1.76in 42mm/1.66in			
Width With Without Brackets	263mm/10.36in 220mm/8.67in			
Depth With Without Handles	148.7mm/5.86in 148.7mm/5.86in			
Weight	0.95kg/2.09lbs			
Regulatory				
Safety and Emission	CE FCC RoHS			

Right Product for the Right Application.

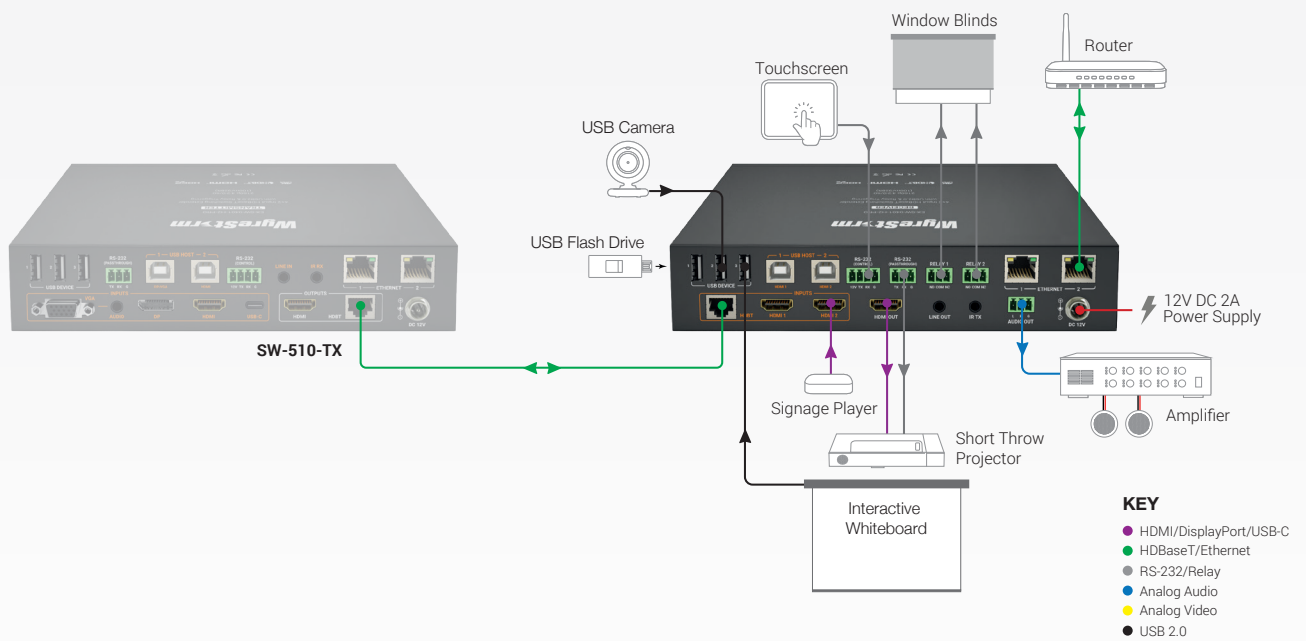

Note: WyreStorm reserves the right to change product specification, appearance or dimensions of this product at any time without prior notice.

2.8" Serial Control Color Touchscreen

TS-280-US | TS-280-EU



WyreStorm - Because the Technology Matters.

Introduction

Introducing the TS-280 to the WyreStorm range. The 2.8" colour touchscreen can control any product within the WyreStorm range; whether it be a presentation switcher or matrix. With ease of use in mind the TS-280 is as easy to use as it is to set up, with pre-configured UI's ready to upload in just seconds via the MicroSD card slot on the rear.

The UI's are simple to use with large buttons clearly labeled for each major function and navigation controls (where applicable) to move between pages. Using a standard RJ45 connection on the rear and RS-422 communication, the TS-280 also comes with an in-line RS-422 to RS-232 converter which doubles as a power-injector if used with a product that doesn't feed the 12v power.

Key Features

- 2.8" color touchscreen perfect for WyreStorm switcher control
- Backlit with automatic power off and wake on touch
- Pre-configured UI's designed for simple end-user experience
- Easy update: Download UI from wyrestorm.com and load via MicroSD card
- RJ45 connection and RS-422 communication to included RS-232 converter
- 300m/984ft transmission range to host device

	Touchscreen		Touchscreen Interface Module
Audio and Video			
Switcher Control	1x RS-422: 8-pin RJ-45 Female		1x RS-232: 4-pin Phoenix
Max Communication Distance	100m/328ft Interface to Touchscreen		15.24m/50ft Switcher to Interface
Power			
Power Supply	12VDC from Touchscreen Interface Module		12V DC from switcher or separate PSU (not included)
Max Power Consumption	0.84W		0.36W
Environmental			
Operating Temperature	0 to + 45°C (32 to + 113 °F), 10% to 90%, non-condensing		
Storage Temperature	-20 to +70°C (-4 to + 158 °F), 10% to 90%, non-condensing		
Maximum BTU	Transmitter: 24 BTU/hr Receiver: 58 BTU/hr		
Dimensions and Weight			
	TS-280-US	TS-280-EU	
Rack Units/Wall Box	2 Gang	2 Gang	<1U
Height With Without Feet	114mm/4.49in	86mm/3.39in	25mm/0.99in
Width With Without Brackets	117mm/4.61in	147mm/5.79in	80.2mm/3.16in
Depth With Without Handles	32.1mm/1.27in	32.1mm/1.27in	50mm/1.97in
Weight	0.30kg/0.66lbs	0.28kg/0.62lbs	0.14kg/0.30lbs
Regulatory			
Safety and Emission	CE FCC RoHS		

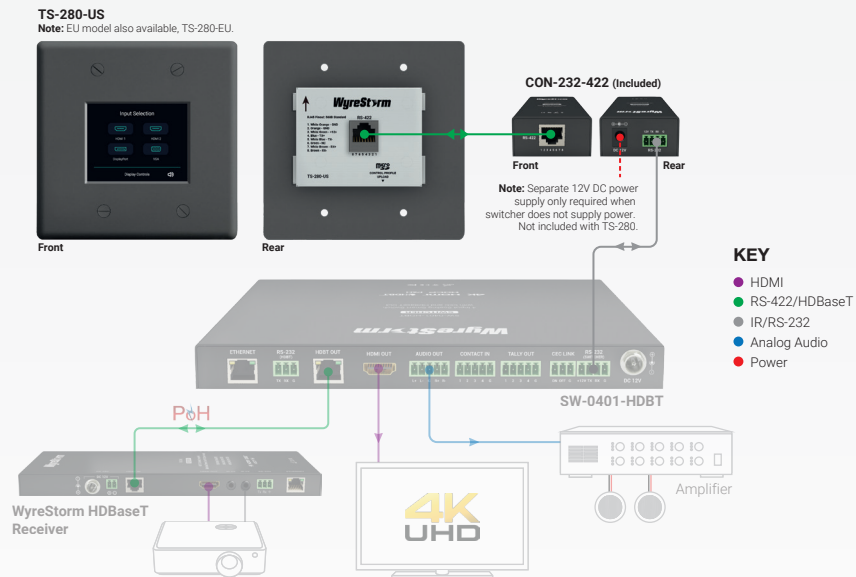

Note: WyreStorm reserves the right to change product specification, appearance or dimensions of this product at any time without prior notice.